

# Low to Mid Voltage Solid Aluminum Conductive Polymer Surface Mount Capacitors



## Sample Kit Contents

KEMET Part Number	VDC	VDC Surge Voltage	Rated Capacitance 120 Hz 20°C (µF)	Case Size D x L (mm)	ESR 100 kHz 20°C (mΩ)	RC 100 kHz 105°C (mA)	LC 20°C 2 Minutes (µA)	Quantity
A765EB397M0ELAE020	2.5	2.9	390	6.3 x 5.7	20	2,800	300	5
A765KN108M0ELAE012	2.5	2.9	1000	8 x 9.7	12	4,260	500	5
A765BC107M0JLAE025	6.3	7.2	100	5 x 6	25	1,700	300	5
A765BG227M0JLAE020	6.3	7.2	220	5 x 7	20	2,700	300	5
A765EB227M0JLAE020	6.3	7.2	220	6.3 x 5.7	20	2,800	300	5
A765KH477M0JLAE016	6.3	7.2	470	8 x 7.5	16	3,220	592	5
A765KN687M0JLAE012	6.3	7.2	680	8 x 9.7	12	5,000	857	5
A765MU158M0JLAE010	6.3	7.2	1,500	10 x 12.6	10	4,100	1,890	5
A765EB157M1ALAE022	10	11.5	150	6.3 x 5.7	22	2,320	300	5
A765KN277M1ALAE020	10	11.5	270	8 x 9.7	20	3,600	540	5
A765MU687M1ALAE013	10	11.5	680	10 x 12.6	13	3,800	1,360	5
A765EB107M1CLAE025	16	18.4	100	6.3 x 5.7	25	2,500	320	5
A765EG157M1CLAE027	16	18.4	150	6.3 x 7	27	2,530	480	5
A765KN227M1CLAE016	16	18.4	220	8 x 9.7	16	3,700	704	5
A765KN277M1CLAE016	16	18.4	270	8 x 9.7	16	3,890	864	5
A765KN337M1CLAE016	16	18.4	330	8 x 9.7	16	3,890	1,056	5
A765MU108M1CLAE018	16	18.4	1000	10 x 12.6	18	4,300	3,200	5
A765EB476M1ELAE040	25	28.7	47	6.3 x 5.7	40	1,200	300	5
A765KN826M1ELAE029	25	28.7	82	8 x 9.7	29	2,700	410	5
A765KN107M1ELAE024	25	28.7	100	8 x 9.7	24	3,300	500	5
A765MU157M1ELAE050	25	28.7	150	10 x 12.6	50	3,800	750	5
A765MU227M1ELAE050	25	28.7	220	10 x 12.6	50	3,800	1,100	5
A765MU337M1ELAE020	25	28.7	330	10 x 12.6	20	2,890	1,650	5

## Dimensions – Millimeters

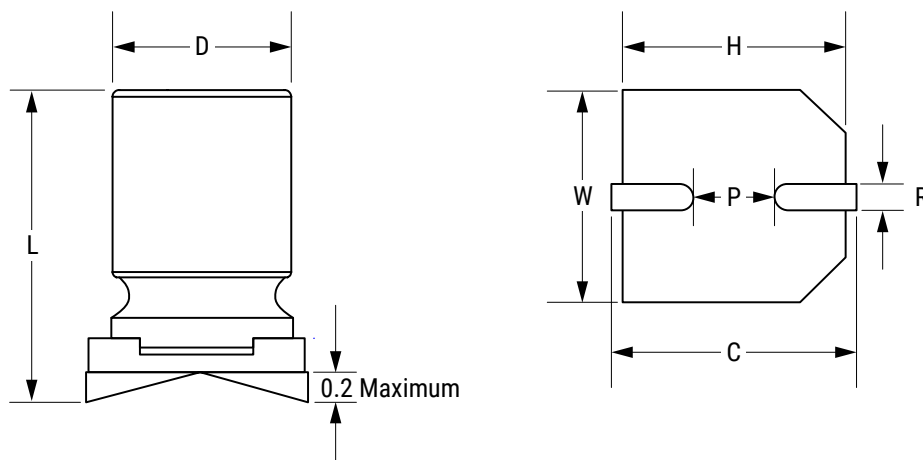

Size Code	D		L		W		H		C		R	P
	Nominal	Tolerance	Nominal	Tolerance	Nominal	Tolerance	Nominal	Tolerance	Nominal	Tolerance	Nominal	Nominal
BC	5	±0.5	6	±0.3	5.3	±0.2	5.3	±0.2	6.0	±0.2	0.5 - 0.8	1.4
BG	5	±0.5	7	±0.3	5.3	±0.2	5.3	±0.2	6.0	±0.2	0.5 - 0.8	1.4
EB	6.3	±0.5	5.7	±0.3	6.6	±0.2	6.6	±0.2	7.3	±0.2	0.5 - 0.8	2.1
EG	6.3	±0.5	7	±0.3	6.6	±0.2	6.6	±0.2	7.3	±0.2	0.5 - 0.8	2.1
EK	6.3	±0.5	8	±0.3	6.6	±0.2	6.6	±0.2	7.3	±0.2	0.5 - 0.8	2.1
EN	6.3	±0.5	9.7	±0.3	6.6	±0.2	6.6	±0.2	7.3	±0.2	0.5 - 0.8	2.1
KH	8	±0.5	7.5	±0.3	8.3	±0.2	8.3	±0.2	9.0	±0.2	0.8 - 1.1	3.2
KN	8	±0.5	9.7	±0.3	8.3	±0.2	8.3	±0.2	9.0	±0.2	0.8 - 1.1	3.2
MU	10	±0.5	12.6	±0.3	10.3	±0.2	10.3	±0.2	11.0	±0.2	0.8 - 1.1	4.6

## KEMET Electronics Corporation Sales Offices

For a complete list of our global sales offices, please visit [www.kemet.com/sales](http://www.kemet.com/sales).

---

### Disclaimer

YAGEO Corporation and its affiliates do not recommend the use of commercial or automotive grade products for high reliability applications or manned space flight.

All product specifications, statements, information and data (collectively, the "Information") in this datasheet are subject to change. The customer is responsible for checking and verifying the extent to which the Information contained in this publication is applicable to an order at the time the order is placed. All Information given herein is believed to be accurate and reliable, but it is presented without guarantee, warranty, or responsibility of any kind, expressed or implied.

Statements of suitability for certain applications are based on KEMET Electronics Corporation's ("KEMET") knowledge of typical operating conditions for such applications, but are not intended to constitute – and KEMET specifically disclaims – any warranty concerning suitability for a specific customer application or use. The Information is intended for use only by customers who have the requisite experience and capability to determine the correct products for their application. Any technical advice inferred from this Information or otherwise provided by KEMET with reference to the use of KEMET's products is given gratis, and KEMET assumes no obligation or liability for the advice given or results obtained.

Although KEMET designs and manufactures its products to the most stringent quality and safety standards, given the current state of the art, isolated component failures may still occur. Accordingly, customer applications which require a high degree of reliability or safety should employ suitable designs or other safeguards (such as installation of protective circuitry or redundancies) in order to ensure that the failure of an electrical component does not result in a risk of personal injury or property damage.

Although all product-related warnings, cautions and notes must be observed, the customer should not assume that all safety measures are indicated or that other measures may not be required.

KEMET requires its products to be packaged and shipped on pallets. This is because KEMET's products are specifically designed to be packed onto pallets during shipment. If for any reason, the products are removed from pallets by the shipping party and shipped to the end customer, then additional external protection is required. In this instance, an external box with two carton layers and an upwards orientation sticker must be used by the shipping party, with the empty space filled with filling material, and afterwards sealing the box. If this packing and packaging guideline is not followed by the shipping party, the shipping party, and not KEMET, will be held responsible for any packaging, packing and/or product damages upon delivery of the products to the end customer. KEMET hereby disclaims any liability for damages to the products or otherwise that have been, or threaten to be, inflicted, result from or are in any way related to the packaging, packing or damage by the shipping party in contravention of the packing and packaging guidelines herein.

*KEMET is a registered trademark of KEMET Electronics Corporation.*